

## Design Summary: Base Plate

### Base Plate Design:

Thickness = 2.5 in  
 Fy = 36 Ksi

### Anchorage Design:

Diameter = 1.125 in  
 Type = Headed Bolt  
 Embed = 20 in  
 Fy = 55 Ksi  
 Fu = 75 Ksi

### Concrete Design:

F'c = 4 Ksi  
 Cracking = No

### Steel Specification:

AISC 360-16

### Concrete Specification:

ACI 318-14

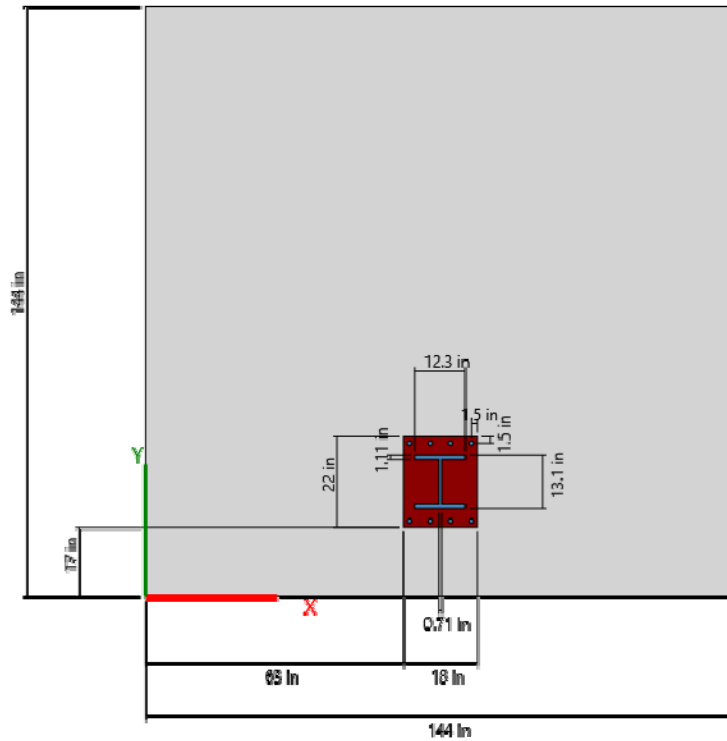

Limit State	Load Key	Demand	Capacity	Unity Value
Concrete Bearing	1	4.42 Ksi	4.42 Ksi	1.000
Plate Bending	1	4.2035 K-ft	4.2188 K-ft	0.996
AnchorageTension	1			
Steel Strength		135.06 K	171.68 K	0.787
Concrete Breakout		135.06 K	163.1 K	0.828
Concrete Pullout		135.06 K	232.19 K	0.582
Concrete Blowout		N.A	N.A	N.A.
Anchorage Shear	4			
Steel Strength		-60 K	89.271 K	0.672
Concrete Breakout		60 K	67.736 K	0.886
Concrete Pryout		60 K	324.77 K	0.185
Anchorage Interaction	1	-	-	0.998
Anchorage Detailing	-	-	-	OK
Plate Detailing	-	-	-	OK